

Yakima County GIS - Washington Land Information Portal

[\[Print Map\]](#)
[\[Close Map\]](#)

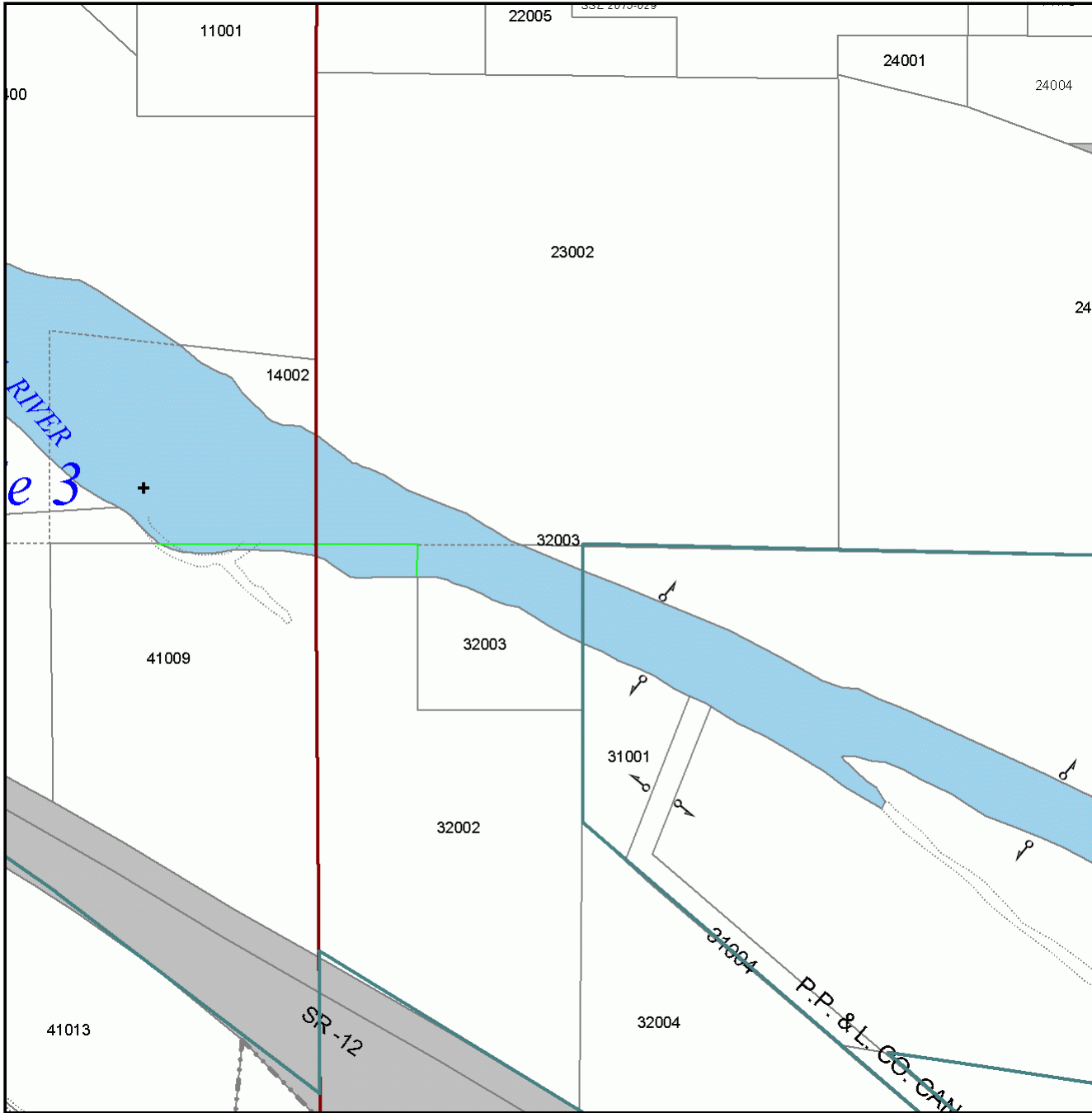

Map Center: Range: **18** Township: **13** Section: **10**

City Limits
 Sections



WWW.YAKIMAP.COM

Yakima County GIS
 128 N 2nd Street
 Yakima, WA 98901
 (509)574-2992



One Inch = 400 Feet

Feet 200 400 600

MAP AND PARCEL DATA ARE BELIEVED TO BE ACCURATE, BUT ACCURACY IS NOT GUARANTEED; THIS IS NOT A LEGAL DOCUMENT AND SHOULD NOT BE SUBSTITUTED FOR A TITLE SEARCH, APPRAISAL, SURVEY, FLOODPLAIN OR ZONING VERIFICATION

Copyright (C) Yakima County GIS
Printed On: 6/23/2018 4:21:52 PM

Yakima County GIS - Washington
Department of Assessment

[\[Print Report\]](#)
[\[Close Report\]](#)

Yakimap.com

PROPERTY PHOTO		PROPERTY INFORMATION AS OF 6/21/2020 11:07:14 PM							
		Parcel Address:		HWY 12/NACHES RIVER, ,WA					
		Parcel Owner(s):		YAKIMA CITY					
		Parcel Number:		18131032003	Parcel Size:		2.77 Acre(s)		
		Property Use:		99 Other Undeveloped Land					
TAX AND ASSESSMENT INFORMATION									
Tax Code Area (TCA):		337		Tax Year:		2020			
Improvement Value:		\$0		Land Value:		\$3000			
CurrentUse Value:		\$0		CurrentUse Improvement:		\$0			
New Construction:		\$0		Total Assessed Value:		\$3000			
RESIDENTIAL INFORMATION									
Quality	Year Built	Stories	Main SqFt	Upper SqFt	Bsmt SqFt	Bedrooms	Bathrooms (full/3/4, 1/2)	Garage (bsmt/att/bltin)	Carport
No Residence Information Found.									
SALE INFORMATION									
Excise	Sale Date	Sale Price	Grantor				Portion		
No Sales Information Found.									
VALUE HISTORY INFORMATION									
Tax Year	TCA	Land	Improvement	New Construction	CurrentUse	CurrentUse Improvement			
2020	337	\$3000	\$0	\$0	\$0	\$0			
2019	337	\$3000	\$0	\$0	\$0	\$0			
2018	337	\$3000	\$0	\$0	\$0	\$0			
2017	337	\$3000	\$0	\$0	\$0	\$0			
2016	337	\$3000	\$0	\$0	\$0	\$0			
2015	337	\$3000	\$3400	\$0	\$0	\$0			
2014	337	\$3000	\$3400	\$0	\$0	\$0			
2013	337	\$3000	\$3400	\$0	\$0	\$0			
2012	337	\$3000	\$3400	\$0	\$0	\$0			
DISCLAIMER									
While the information is intended to be accurate, any manifest errors are unintentional and subject to correction. Please let us know about any errors you discover and we will correct them. To contact us call either (509) 574-1100 or (800) 572-7354, or email us .									

OVERLAY INFORMATION			
Zoning:	R-10/5	Jurisdiction:	County (Urban Area Zoning Ordinance)
Urban Growth Area:	Yakima	Future Landuse Designation:	(LD) Low Density Residential (Yakima Urban Area Plan)
FEMA:	FEMA Map	FIRM Panel Number:	53077C0714D
LOCATION INFORMATION			
+ Latitude:	46° 37' 44.333"	+ Longitude:	-120° 34' 12.957"
Range:	18	Township:	13
Section: 10			
Narrative Description: TH PT OF NW1/4 NW1/4 SW1/4 BEG ATA PT 2222.6 FT N & 242.6 FT E OF SWCOR OF SEC.& TRUE PT OF BEG.TH E417.4 FT M OR L TO E LN OF NW1/4NW1/4 SW1/4,TH N 417.4 FT,TH WTO A PT 242.6 FT E OF W SEC.LI,THS 417.4 FT M OR L TO TRUE PT OF BEG.			
DISCLAIMER			
MAP AND PARCEL DATA ARE BELIEVED TO BE ACCURATE, BUT ACCURACY IS NOT GUARANTEED; THIS IS NOT A LEGAL DOCUMENT AND SHOULD NOT BE SUBSTITUTED FOR A TITLE SEARCH, APPRAISAL, SURVEY, FLOODPLAIN OR ZONING VERIFICATION			